

PDR - ROTARY ACTUATORS

Benefits

- Double acting pneumatic rotary actuator with adjustable end cushioning to operate hatches and doors
- Maximum torque at the end positions

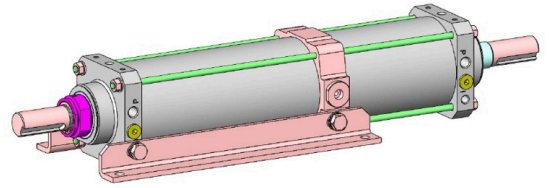

TECHNICAL DETAILS

Operating medium	Compressed air, filtered to 40 µm, lubricated or without lubrication
Optional output torque	Maximum torque at closed position to keep the door closed - minimum in the middle
Rotary angle	170°
Pressure range	1...10 bar
Ambient temperature range	-20-+70°C
Materials	End caps and cylinder barrel - Anodized aluminium Piston rods - AISI303 chrome plated stainless steel Mounting parts - AISI316L stainless steel Piston rod nut - Zinc plated steel Plugs - Brass